

# PQ PROTECTION SURGE PROTECTION DEVICES

## PQ360 SERIES



PQ360 is a high-performance, robust surge protective device (SPD) with advanced features, protecting your facility's electrical equipment from damaging electrical power surges due to lightning; utility power generation/distribution systems; and inductive load switching equipment within your facility. PQ360 is intended for Service Entrance and large equipment applications, incorporating integral rotary disconnect switch.

The PQ360 standard series is UL Type 1 listed (automatically suitable for UL Type 2) and can be installed before or after the service equipment overcurrent device, with or without a dedicated circuit breaker for the SPD.

The PQ360-F with EMI Filter option is UL Type 2 listed and can be installed after the service equipment overcurrent device. The PQ360-F series protects your facility equipment from internally generated transients such as oscillatory ring waveforms which are typically due to switch-mode power supplies (most modern electronic equipment).

The PQ360 is automatic in operation, resetting after activation to provide continuous protection of electrical equipment.

Proudly **Made in the USA**, **ISO 9001:2014** Quality Management System, **ISO 17025:2007** Laboratory Certification (**UL® DAP**), and 100% Quality Tested prior to shipping.

### PRODUCT SPECIFICATIONS

<b>Status Indication</b>	Two tri-color LEDs per Phase / Line / Protection Mode Rotatable Color Graphics LCD for Status, Resettable Surge and TOV Counter, Event History with time & date stamp Audible Alarm with Silence Function
<b>Disconnecting means</b>	Integral rotary disconnect switch
<b>Certifications</b>	Standard Models <b>UL® 1449 Edition 5</b> Type 1 / Type 2 EMI Filter Models <b>UL® 1449 Edition 5</b> Type 2, <b>UL® 1283</b>
<b>Complies With</b>	<b>NEC® Article 242 (Article 285 - prior to 2020)</b> <b>UL® 96A Edition 14</b> Installation Requirements for Lightning Protection Systems <b>ANSI®/IEEE® C62.41.1-2002</b> Category A, B, and C; <b>C62.41.2-2002</b> ; and <b>C62.45-2002</b> <b>MIL-STD-220A</b> – EMI Filter Models
<b>Short Circuit Current Rating (SCCR)</b>	200 kA
<b>Maximum Discharge Current (I<sub>max</sub>)</b>	360 kA per phase / 180 kA per mode - 8/20 μs
<b>Nominal Discharge Current (I<sub>n</sub>)</b>	20 kA
<b>Impulse Life</b>	10,000 Impulses at 10 kA 8/20 μs
<b>Frequency</b>	0 – 600 Hz
<b>Filtering (EMI Filter Models)</b>	-30 dB > 50 kHz, -45 dB > 250 kHz
<b>Operating Temperature</b>	-31° to 167°F (-35 to 75°C)
<b>Mounting</b>	Flange Mount
<b>Enclosure Rating</b>	<b>NEMA® Type 4, UL® 50E</b> Type 4, suitable for indoor or outdoor installation
<b>Enclosure Material</b>	Metal
<b>Dimensions</b>	16.79 H x 13.19 W x 7.23 D in., 18.2 lb
<b>Connection Method</b>	Parallel, mechanical lugs, rated 10 – 4 AWG
<b>Remote Monitoring Contacts</b>	Form C, 5 A @ 240 V, 22-14 AWG stranded - IoT, BMS, and SCADA compatible
<b>Warranty</b>	Ten (10) Years

# PQ PROTECTION SURGE PROTECTION DEVICES

## PQ360 SERIES



STANDARD MODELS   PQ360		MCOV	VPR			
Model Number	Configuration	(V)	L-G (V)	L-N (V)	N-G (V)	L-L (V)
PQ360-120/208-3Y	120/208V, 3-phase Wye, 4W+G	150 / 300	800	800	800	1000
PQ360-277/480-3Y	277/480V, 3-phase Wye, 4W+G	320 / 700	1200	1200	1200	2000
PQ360-347/600-3Y	347/600V, 3-phase Wye, 4W+G	420 / 880	1500	1500	1500	2500
PQ360-240-3D	240V, 3-phase Delta, 3W+G	280	1000	-	-	1200
PQ360-480-3D	480V, 3-phase Delta, 3W+G	550	1800	-	-	1800
PQ360-120/240-HLD	120/240V, High-leg Delta, 4W+G	175 / 275	1000 / 1000	800 / 1000	800	1200 / 1500
PQ360-240/480-HLD	240/480V, High-leg Delta, 4W+G	350 / 550	1800 / 1800	1200 / 1800	1200	2000 / 2500
PQ360-120/240-SP	120/240V, Split-phase, 3W+G	175 / 350	800	800	800	1800
PQ360-240/480-SP	240/480V, Split-phase, 3W+G	320 / 550	1200	1200	1200	2500

EMI FILTER MODELS   PQ360-F		MCOV	VPR			
Model Number	Configuration	(V)	L-G (V)	L-N (V)	N-G (V)	L-L (V)
PQ360-F-120/208-3Y	120/208V, 3-phase Wye, 4W+G	150 / 300	800	800	800	1000
PQ360-F-277/480-3Y	277/480V, 3-phase Wye, 4W+G	320 / 700	1200	1200	1200	2000
PQ360-F-347/600-3Y	347/600V, 3-phase Wye, 4W+G	420 / 880	1500	1500	1500	2500
PQ360-F-240-3D	240V, 3-phase Delta, 3W+G	280	1000	-	-	1200
PQ360-F-480-3D	480V, 3-phase Delta, 3W+G	550	1800	-	-	1800
PQ360-F-120/240-HLD	120/240V, High-leg Delta, 4W+G	175 / 275	1000 / 1000	800 / 1000	800	1200 / 1500
PQ360-F-240/480-HLD	240/480V, High-leg Delta, 4W+G	350 / 550	1800 / 1800	1200 / 1800	1200	2000 / 2500
PQ360-F-120/240-SP	120/240V, Split-phase, 3W+G	175 / 350	800	800	800	1800
PQ360-F-240/480-SP	240/480V, Split-phase, 3W+G	320 / 550	1200	1200	1200	2000

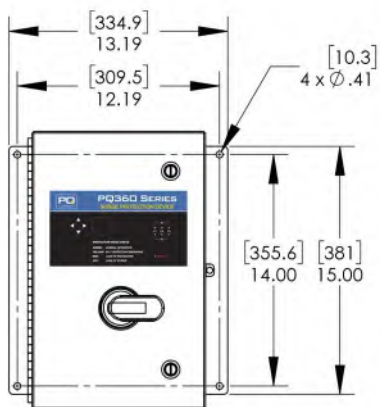

The EMI Filter option mitigates oscillatory ring waveforms – generally caused by non-linear loads inside the facility.

Typical oscillatory ring waveform sources include “transformer-less” switching power supplies for computers, IT equipment (network, monitors, printers), TVs, electronic ballasts for lighting, UPS, Inverter, Rectifier systems, and Variable Frequency (speed) Drives.

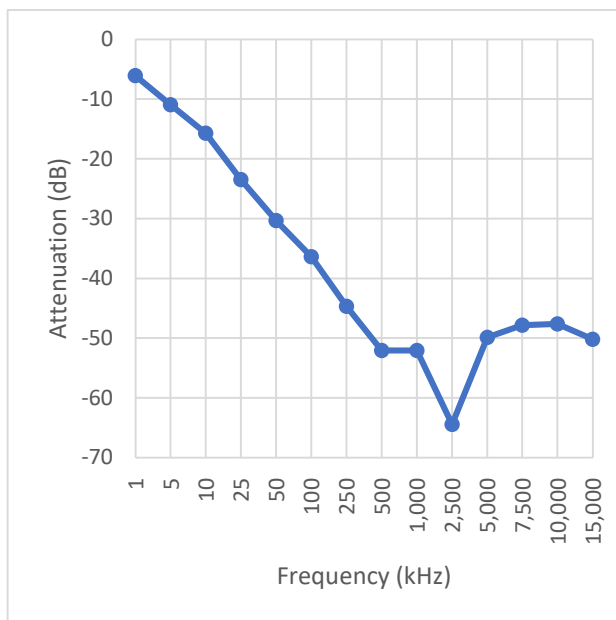
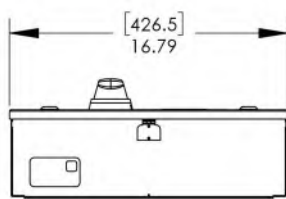
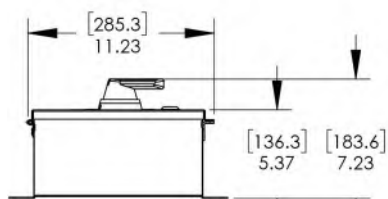

### CONFIGURATIONS (Conceptual - refer to IOM for installation instructions)

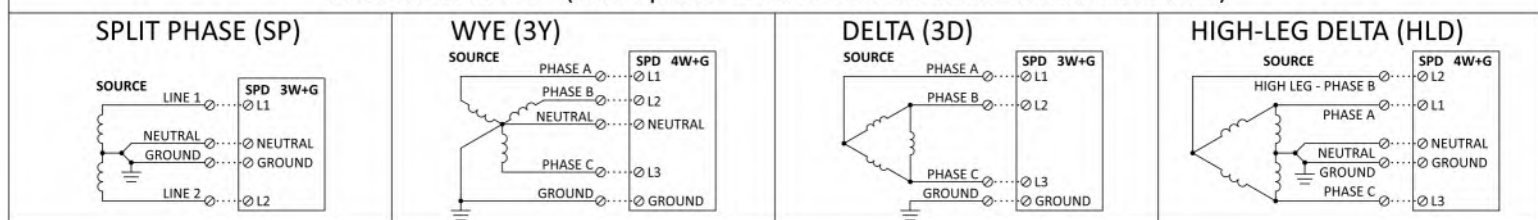

Document issued 2025-02-25